

TLD-15 EXPLODED PARTS VIEWS

SHIMANO

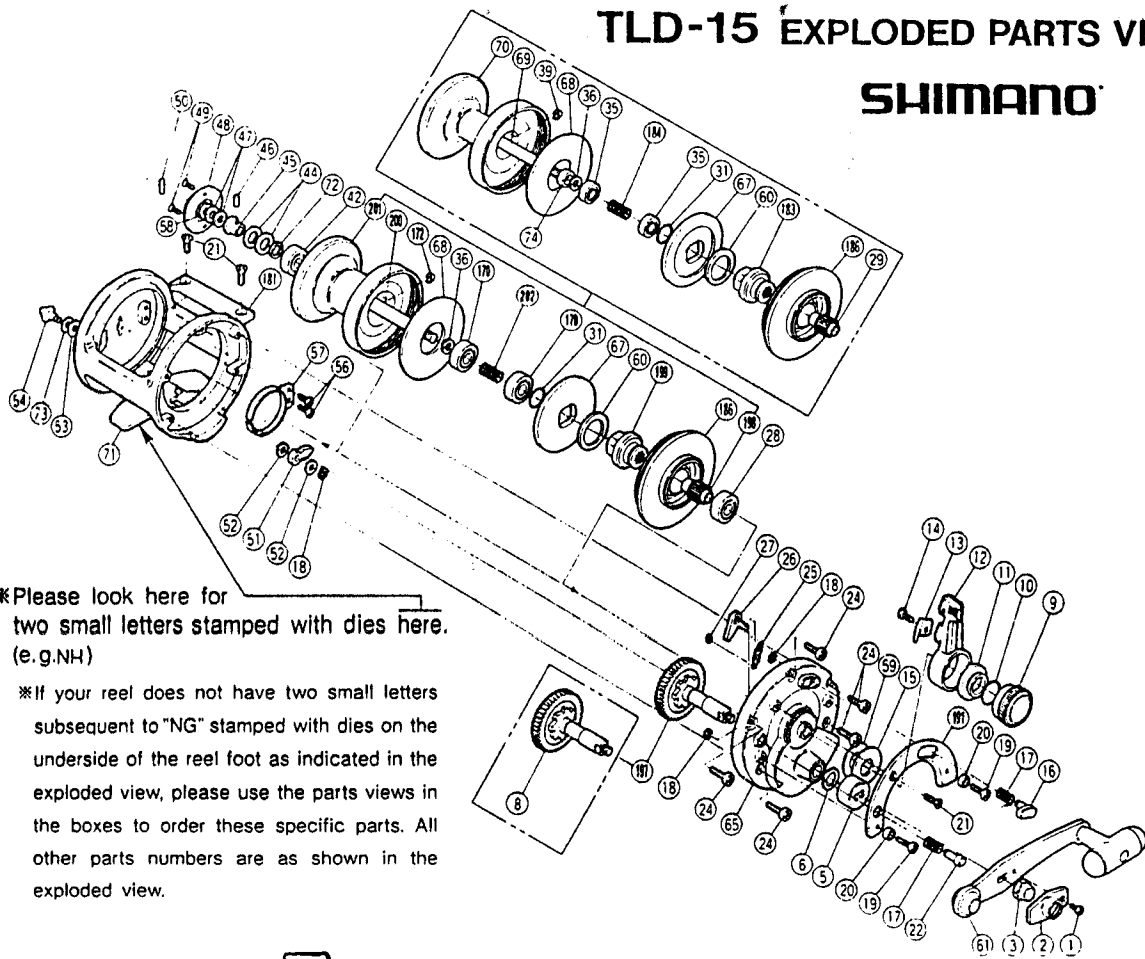

*Please look here for two small letters stamped with dies here. (e.g.NH)

*If your reel does not have two small letters subsequent to "NG" stamped with dies on the underside of the reel foot as indicated in the exploded view, please use the parts views in the boxes to order these specific parts. All other parts numbers are as shown in the exploded view.

TLD-15 PARTS LIST 92

Use this Page

TLDNo.	PARTS NAMES	TLDNo.	PARTS NAMES	TLDNo.	PARTS NAMES
0001	Handle Lock Screw	0031	Seal Lock	0072	Pre-Load Washer A
0002	Handle Lock	0036	Bearing Thrust Washer	0073	Click Button Washer B
0003	Handle Nut	0042	Ball Bearing (with oil)	0170	Ball Bearing
0005	Gear Shaft Shield	0044	Pre-Load Spring B	0172	"C" Lock
0006	Gear Shaft Thrust Washer	0045	Pre-Load Body	0181	Line Guard
0009	Pre-Program Dial	0046	Cross Pin A	0186	Cooling Shield
0010	Body "O" Seal	0047	Spacer A	0191	Lever Quadrant
0011	Lever Shaft Body	0048	Click Gear	0197	Main Gear
0012	Drag Control Lever	0049	Click Gear Screw	0198	Pinion Gear
0013	Lever Click Spring	0050	Cross Pin B	0199	Pinion Guard
0014	Click Spring Screw	0051	Click Pawl	0200	Main Shaft
0015	Lever Thrust Ring	0052	Click Pawl Washer	0201	Spool
0016	Strike Stop	0053	Click Button Washer A	0202	Pressure Release Spring
0017	Pressure Spring	0054	Click Button		
0018	"C" Lock	0056	Click Spring Screw		
0019	Quadrant Anchor Bolt	0057	Click Spring	0008	Main Gear
0020	Bolt Shield	0058	Spacer B	0029	Pinion Gear
0021	Quadrant Screw	0059	Spacer	0035	Ball Bearing
0022	Free Spool Detent	0060	Pre-Load Spring A	0039	"C" Lock
0024	Side Plate Bolt	0061	Handle	0069	Main Shaft
0025	Dog Spring	0065	Side Plate	0070	Spool
0027	Dog	0067	Drag Plate	0074	Bushing
0027	Dog Spring Retainer	0068	Titanium Drag Washer	0183	Pinion Guard
0028	Ball Bearing (with grease)	0071	One-Piece Body	0184	Pressure Release Spring